



5



3



2

PRICE GUIDE: SOLD \$1,705,000.

Area: 428 m2

SOLD: Another Happy Vendor and Proud New Owners

Idyllic Family Lifestyle On A Grand Scale - Land 428sqm

Model-like five bedroom home with room for the entire family.

Showcasing grand interiors and private alfresco entertaining, this beautifully designed family residence offers instant family appeal. Designed by Mirvac for an effortless modern lifestyle, this 9 year young home is situated on an impressive 428sqm corner block in one of the most sought-after streets in Newington.

From its wide entry foyer with high ceilings to the state of the art Miele kitchen and beautifully appointed double bedrooms, this exquisite executive entertainer offers growing families relaxed living with convenience, space and style.

- Light-filled open plan family living areas blend seamlessly with two separate alfresco settings to offer the ultimate indoor/outdoor



Chuck Lee
0402 372 286



Matthew Hamilton



OFFICE

26 Tooth Avenue , NEWINGTON

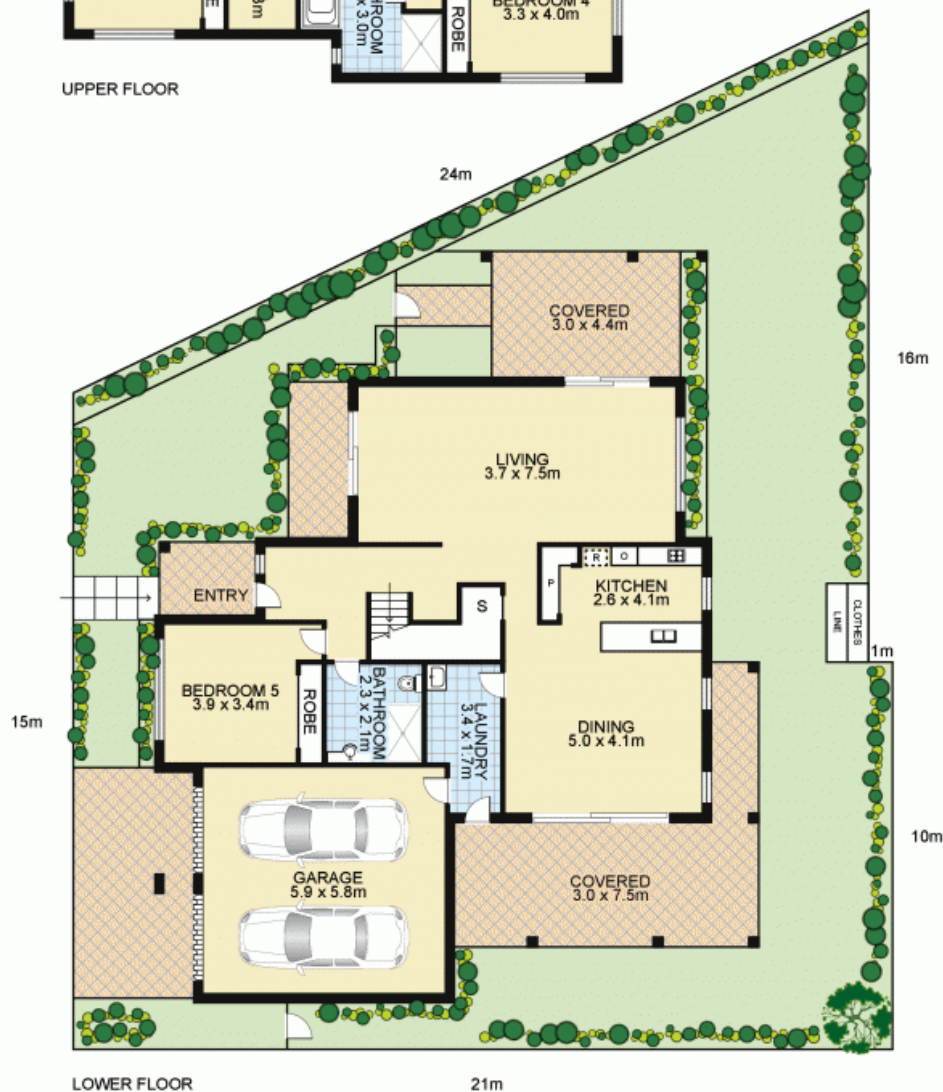

This floor plan is intended as a guide only. Layout dimension are approximate only. No representation or warranties of any nature whatsoever are given or intended. Any person using this information should rely on their own enquiries.



NVre

Land Size : 428m²



OFFICE